



*Transforming smart to **Smartest***

Installation Manual

What you'll need to install your Altro Smart Lock:

- To install your Altro Smart Lock you'll need only a Philips screwdriver.
- To view door compatibility guide and for preparing your door for installing Altro Smart Lock, please visit- <https://www.altrosmart.com/install/>

1.

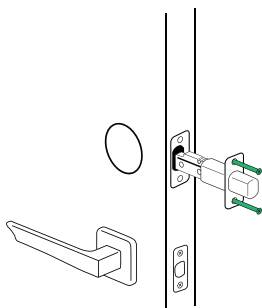

- Remove your existing lock from your door, insert the provided latch, and secure it in place, ensuring the "Up" sign is pointing upwards.

2.

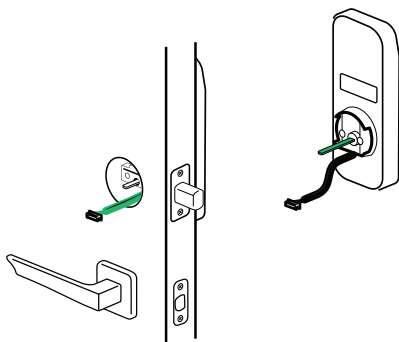

- Rotate the latch to the locked position, as shown in the above image.
- Place the outer unit on the exterior of your door and pass the connector cable, from below the latch, through the hole.
- Rotate the lock cylinder tailpiece clockwise (for a left-hand door) counterclockwise (for a right-hand door) till it stops and can not be turned any further.
- Insert the lock cylinder tailpiece through the center of the latch.

3.

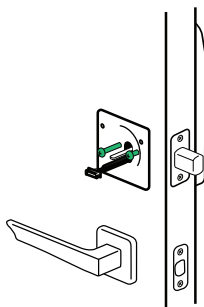

- Adhere the outer unit and inner mounting plate in parallel and secure them in place with the provided screws, as shown.

4.

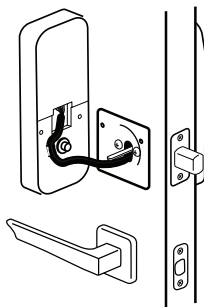

- Connect the free end of the connector cable to the cable connector present on the back of the inner unit.
- Rotate the knob clockwise (for left-hand door) counterclockwise (for right-hand door) till it stops and can not be turned any further.
- Insert lock cylinder tailpiece in the knob cavity at the back of the inner unit.
- Place the inner unit on to the mounting plate.

5.

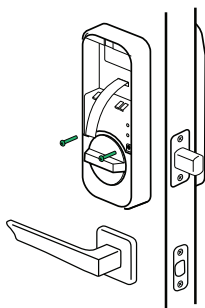

- Secure inner unit to the mounting plate, using provided screws as shown.
- Rotate the knob and test the movement of the latch.

6.

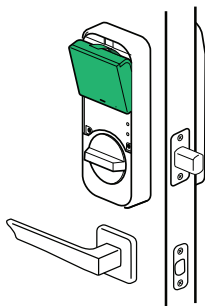

- Insert the battery pack into the inner unit's battery compartment, as shown. The ribbon will pass over the top of the battery pack.

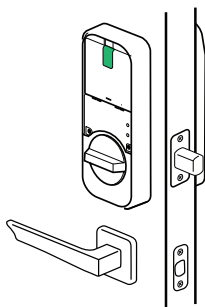

7.

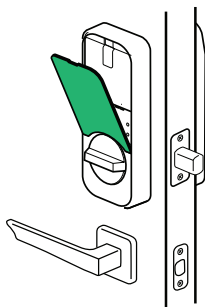

- Use the battery cover to close the battery compartment and your Alto Smart Lock is ready to use!

Support

To watch Installation video and online support, please visit www.altrosmart.com support section.

To reach an expert, write to us at support@altrosmart.com